



HUNT GROUP

INTERNATIONAL ARMS & SECURITY

**XRP PUMP ACTION
SERIES**

INSTRUCTION MANUAL

READ THE INSTRUCTIONS AND
WARNINGS IN THIS MANUAL
CAREFULLY BEFORE USING THIS
FIREARM

QUALITY CONTROL - WARRANTY CARD

Serial No. of weapon _____ Model _____

Manufacturer _____

Caliber _____ Year of manufacture _____ Barrel Length _____

Number of Cartridges and grams of cartridges tested _____

Chamber details _____

PURCHASER _____

Address _____

Purchase date _____

Signature _____

PLEASE SIGN AND RETURN THIS CARD TO VALIDATE WARRANTY



HUNT GROUP

INTERNATIONAL ARMS & SECURITY

**XRP PUMP ACTION
SERIES**

INSTRUCTION MANUAL

GUN SAFETY RULES

Observe these rules of safe gun handling.

1. Always keep the muzzle pointed in a safe direction. Watch the muzzle at all time, never point a gun accidentally or intentionally, at any person or anything you do not intend to shoot. Identify the target before shooting; do not shoot at sounds.
2. Always treat a gun as if it is loaded - it may be!
3. Keep your finger off the trigger while operating the action and at all other times until you are ready to shoot.
4. Keep the safety "on" or in the "safe" position at all times until you are ready to fire. Do not rely on your gun's safety, the safety on any gun is a mechanical device and is not intended as a substitute for common sense or safe gun handling.
5. Learn how your gun functions and handles. If you do not thoroughly understand the proper use and care of your gun, seek the advice of someone who is knowledgeable.
6. Do not alter or modify any part of the firearm.
7. Store guns unloaded, separate from any ammunition, and out of the reach of children.
8. Be sure the barrel is clear of any obstructions before loading. Make it a habit to check the barrel every time before loading.
9. Be sure you have and use the proper ammunition.
10. Wear protective eye protection glasses and adequate ear protection when shooting.
11. Never climb or jump over anything, such as a tree, fence, or ditch, with a loaded gun. Remove the shells and hand the gun to someone else or place it on the ground on the other side of the obstacle before crossing it yourself. Do not lean a gun against a tree or other object; it could fall and possibly discharge.
12. Do not shoot at a hard surface or at the water. Bullet and shot can ricochet or bounce off and travel in unpredictable directions with great velocity.
13. Never transport a loaded gun. Do not place a loaded gun into a vehicle. The gun should be unloaded and placed into a case when not in use.
14. Never drink alcoholic beverages before or during shooting.

MAINTENANCE AND CLEANING

Caution: Make sure the gun is UNLOADED.

1. Your MH-PX shotgun is a precision instrument and will provide a lifetime of faithful service if it is properly cleaned and maintained. It is recommended that you clean your MH-PX after every shooting session or more frequently if needed. Be sure to unload your MH-PX before servicing or cleaning.

2. Run an oil patch through the bore with a cleaning rod starting from the breech end to prevent leading, use a cleaning solvent and brass brush to clean the bore periodically. Follow this cleaning with one or two clean oil patches. Important: If your gun is equipped with choke tubes, do not use a brass brush to clean the barrels without having a choke tube installed. Barrels that utilize choke tubes must also have the choke tubes removed to clean and oil the threads inside the barrel and the choke tubes themselves. This will protect the threads and prevent dirt buildup that can cause tubes to become difficult to remove.

INTRODUCTION TO HUNT GROUP ARMS

Hunt group arms is a leading company producing shotguns in Turkey since 1992.

Currently the company is exporting its products to more than 20 countries and we are marketing the guns across the globe.

Hunt group company is an integrated structure capable of producing high quality products with the latest technologies. We at HUNT GROUP ARMS thank you for the privilege of delivering a product to you that will provide you with years of pleasurable use.

ABOUT YOUR PUMP SHOTGUN

This shotgun is manually operated. It's a pump-action shotgun with different magazines capacities like 2+1, 5+1 to a maximum of 10+1. It also has different barrel options and various colour options. It also has multiple stock options.

When you are ready to fire move the safety pin towards the red point push the forend to the back and than also pull towards the front side. Now you gun is loaded and is ready to fire.

SAFETY SWITCH OR BUTTON

This safety mechanism is designed to stop the trigger mechanism. **DON'T RELY ON YOUR GUN'S SAFETY, TREAT EVERY GUN AS IF IT WAS LOADED AND READY TO FIRE.** The safety on any gun is a mechanical device, and it is not intended as a substitute for common sense or safe gun handling. Always keep the muzzle pointed in a safe direction.

A- The safety is located above the trigger, and provides protection against accidental or unintentional discharge under normal usage when properly used.

B- To engage the safety, push the button to the right so that it points towards the white mark, trigger is lock in this position and you are safe. When you move the safety pin towards red mark which is pallel to the trigger it means the gun is ready to fire. The safety pin should always be in the "White point" until you intend to fire the gun.

DANGER: The gun will fire when the trigger is pulled intentionally or accidentally when the **RED BAND MARKING IS SHOWING.**

SAFETY SWITCH OR BUTTON

The safety is designed to stop the trigger mechanism. Don't rely on your Gun's Safety, Treat every gun as if it were loaded and ready to fire. The safety on any gun is a mechanical device, and it is not intended as a substitute for common sense or safe gun handling. Always keep the muzzle pointed in a safe direction.

A- The safety is located behind the trigger, and provides protection against accidental or unintentional discharge under normal usage when properly used.

B- To engage the safety, push the button so that it protrudes from the right side of the gun and the **RED BAND MARKING CAN NOT BE SEEN**. The safety should always be in the "on" or "safe" position until you intend to fire the gun. (PHOTO 1)

C- When you are ready to fire the gun, press the safety button to the "off" position so that the safety protrudes from the left side of the gun and the **RED BAND MARKING IS SHOWING**.

DANGER : The gun will fire when the trigger is pulled intentionally or accidentally when the **RED BAND MARKING IS SHOWING**.

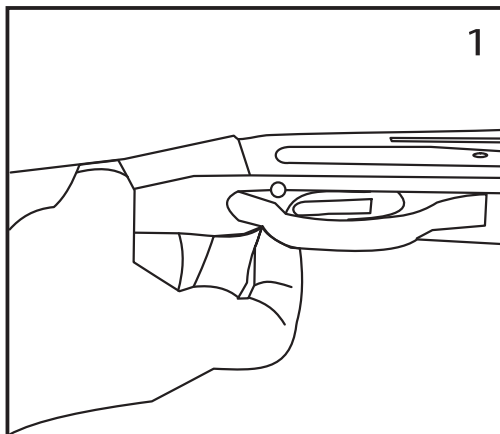

ASSEMBLY

- 1 - Remove the magazine cap.
- 2 - Press upward on the action bar lock. Pull the forearm approximately halfway rearward.
- 3 - Hold the barrel ahead of the barrel guide ring. (See Picture 2)
- 4 - Slide the barrel guide ring over the magazine tube. Clean the barrel following the instructions on Page 12.
- 5 - Press upward on the action bar lock.
- 6 - Align the ejector on the inside of the barrel with the slot in the bolt.
- 7 - Carefully set the barrel into the receiver. **DO NOT FORCE IT !**
- 8 - Replace the magazine cap. Tighten.

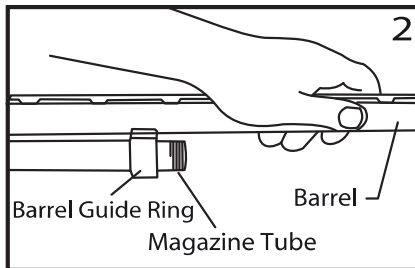

DISASSEMBLY

- 1 - Make sure the gun is unloaded!
- 2 - Point firearm in a safe direction.
- 3 - Point firearm in a safe position.
- 4 - Push up on the action bar lock.
- 5 - Slide forearm forward halfway.
- 6 - Unscrew and remove the magazine cap.
- 7 - Pull the barrel carefully out of the receiver.
- 8 - Push the carrier forward.
- 9 - Depress and hold the action bar lock.
- 10 - Slide the forearm forward and off the magazine tube.

LOADING YOUR SHOTGUN ONE SHELL ONLY

- 1 - Put safety in the 'on' position.
- 2 - Point the gun in a safe direction.
- 3 - Push up on the action bar lock.
- 4 - Pull the forearm completely to the rear.
- 5 - Put one shell through the ejection port, marking sure it is the correct gauge and length. (See picture 3)
- 6 - Push the forearm forward and close the action.

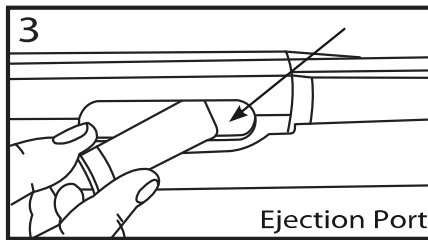

FULLY LOADING YOUR SHOTGUN

- 1 - Put safety in the 'on' position.
- 2 - Point the gun in a safe direction.
- 3 - Push up on the action bar lock.
- 4 - Pull the forearm completely to the rear.
- 5 - Put one shell through the ejection port, marking sure it is the correct gauge and length. (See picture 4)

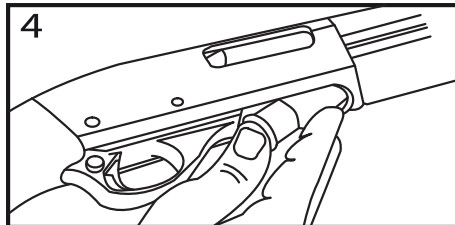

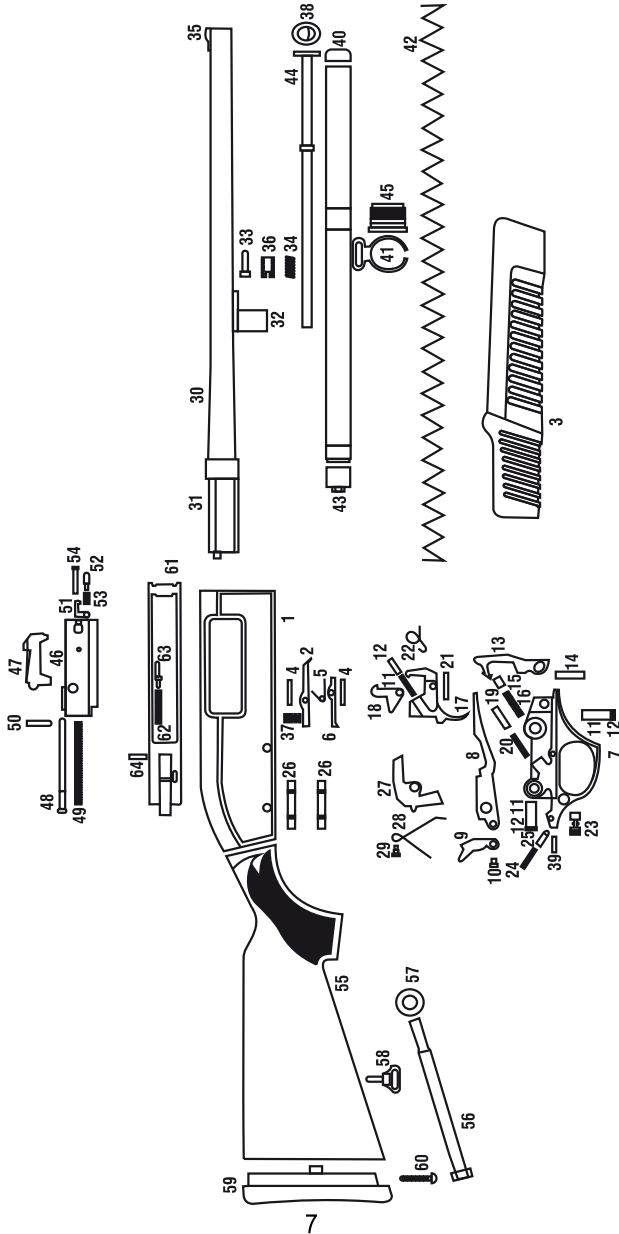

1 - RECEIVER	23 - SAFETY	44 - PLUG
2 - CARRIER LATCH	24 - SAFETY SPRING	45 - MAGAZINE BOLT CAP
3 - FORE-END	25 - SAFETY CAPSULE	46 - BOLT ACTION
4 - CARRIER LATCH PIN	26 - CAPSULE PIN	47 - LOCKING BLOCK
5 - CARTRIDGE HOLDER SPRING	27 - UNLOADING LATCH	48 - FIRING PIN
6 - CARTRIDGE HOLDER	28 - UNLOADING LATCH SPRING	49 - FIRING PIN SPRING
7 - TRIGGER GROUP	29 - UNLOADING LATCH SPRING SCREW	50 - FIRING PIN HOLDER
8 - CARTRIDGE CARRIER	30 - BARREL	51 - EXTRACTOR
9 - CARTRIDGE LIFTER	31 - BARREL LUG	52 - EXTRACTOR PIN
10 - CARTRIDGE LIFTER PIN	32 - PUMP RING	53 - EXTRACTOR SPRING
11 - INTERNAL SAFETY SPRING	33 - PUMP RING PIN	54 - EXTRACTOR SPRING PIN
12 - INTERNAL SAFETY SPRING CASE	34 - PUMP RING SPRING	55 - GRIP
13 - HAMMER	35 - D RING TRIGGER FRAME PIN	56 - HEAT SHIELD
14 - HAMMER PIN	36 - PUMP RING SCREW	57 - HEAT SHIELD SCREW
15 - HAMMER PIN CAPSULE	37 - METAL HOLDER SPRING	58 - SLING SWIVEL
16 - HAMMER SPRING	38 - PLUG CAP	59 - GRIP KEY
17 - TRIGGER	39 - SAFETY PIN	60 - GRIP SCREW
18 - INTERNAL SAFETY	40 - MAGAZINE UPPER CAP	61 - SLIDING BAR
19 - INTERNAL SAFETY CAPSULE	41 - SLING SWIVEL	62 - SLIDING BAR SPRING
20 - INTERNAL SAFETY CAPSULE SPRING	42 - MAGAZINE SPRING	63 - SLIDING BAR PIN
21 - TRIGGER PIN	43 - CARTRIDGE EJECTOR PLUG	64 - SLIDING BAR RIVETING PIN
22 - TRIGGER SPRING		

USAGE OF CHOKE TUBES

The choke controls how open or tight the pattern of the shot will be. The chart below lists the chokes available (from open to tight), and the cores pending marks that indicate the specific choke.

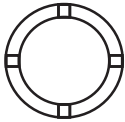
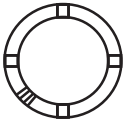
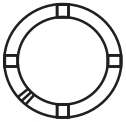
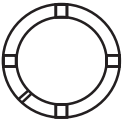
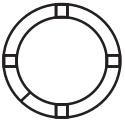
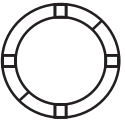
	SKEET	IC	M	IM	F	XF
CHOKE TUBE						
BBSL	C L	****	***	**	*	XF

Never fire your gun or run cleaning tools through a barrel that uses a choke tube without having a choka installed. The threads of the choke tube and the internal threads of the barrel should be cleaned after each use and before installation of the tube. Your Hunt Group Arms shotgun uses choke tubes. To install a tube, insert the tube into the top of the barrel and tighten with your fingers. Once the tube is finger tightened, tighten the rest of the way with the appropriate choke tube wrench until the tube is snug. Do Not over tighten or forcefully tighten with the wrench.

MAINTANCE AND CLEANING

Caution : Make sure the gun is UNLOADED.

1. Make sure the broad, polished finely fitted mating surface of the breech block and receiver is especially clean and lightly oiled with high quality gun oil Do not use silicone or lanolin (Do not use WD-40).
2. Run an oil patch through the bore with a cleaning rod starting from the breech end. To prevent leading, use a cleaning solvent and brass brush to clean the bore periodically. Follow this cleaning with one ore two clean oil patches. Important : If your gun is equipped with choke tubes, do not use a brass brush to clean the barrels without having a choke tube installed. Barrels that utilize choke tubes must also have the choke tubes removed to clean and oil the threads inside the barrel and the choke tubes themselves. This will protect the threads and prevent dirt build up that can cause tubes to become difficult to remove.

Never fire your gun without choke tubes snugly tightened in barrels. Do not over tighten choke tubes. Wipe all exposed metal surface with an oiled cloth before storing. Do not squirt or pour oil into the inside mechanism because it may hamper proper functioning. After extended periods of heavy use, your gun should be taken to a qualified gunsmith to have the action disassembled for professional cleaning and lubrication.

3. Care for your wood stock and forearm the same way you would a piece of furniture with the same finish.

SERVICE AGREEMENT AND LIMITED WARRANTY

Hunt Group Arms agrees to service its products free of charge for defects in materials and workmanship in accordance with the service agreement listed below. The obligation of Hunt Group Arms under this agreement is limited to the repair or replacement of unserviceable parts and does not cover any incidental or consequential damages. Other than the express warranty contained herein Hunt Group Arms makes no warranties, express or implied.

Hunt Group Arms will repair or replace any unserviceable part(s) for one (1) year from date of purchase and further will supply free parts (Wood not included) for an additional one (1) year in accordance with the above warranty statement provided your firearm had not been altered, abused, willfully damaged, or damaged by overpressure ammunition. This agreement is not transferable; its benefits apply only to the original purchaser. To obtain free service during the time this agreement is in effect, make sure your firearm is unloaded, and send it to Hunt Group Arms

This agreement and the warranties contained herein are void if your registration card is not received with a copy of your sales slip within 30 days from date of purchase.

SHIPPING

When returning your gun for service, please take care in packing. Disassemble your gun, wrap in paper or other protective material and place gun in the original box. (This Box Will Protect The Gun But Is Not Designed For Shipping). Wrap box in a cardboard box approved for interstate shipping. Hunt Group Arms is not responsible for damage incurred during shipping.



HUNT GROUP
INTERNATIONAL ARMS & SECURITY



BE COURTEOUS

When shooting or hunting always acquire the permission of the landowner. Respect the land.

Do not litter, use gates when possible, leave open and closed gates closed. Drive vehicles only where advance permission has been granted and always express gratitude for use of another person's land.

Offer your labour or game as repayment for the privilege of use. Remember you are helping develop a reputation for all sportsmen/sportswomen.

HUNT GROUP SİLAH OTOM. SAN. ve TİC. LTD. ŞTİ.
Müftü Mahallesi 41117. Sokak A Blok No : 2B - Beyşehir - KONYA / TURKEY
Web : www.huntgrouparms.com
E-mail : export@huntgrouparms.com